

eduard
MASK

EX 240

Fi 156C Storch

The die-cut mask for accurate canopy frame painting of the
Tamiya scale 1/48 KIT

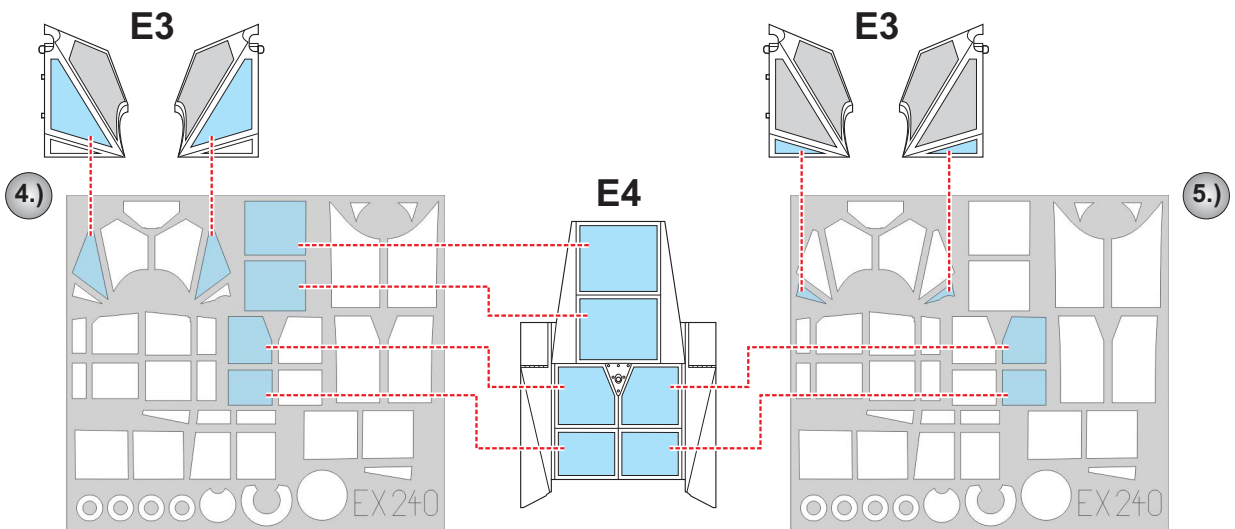
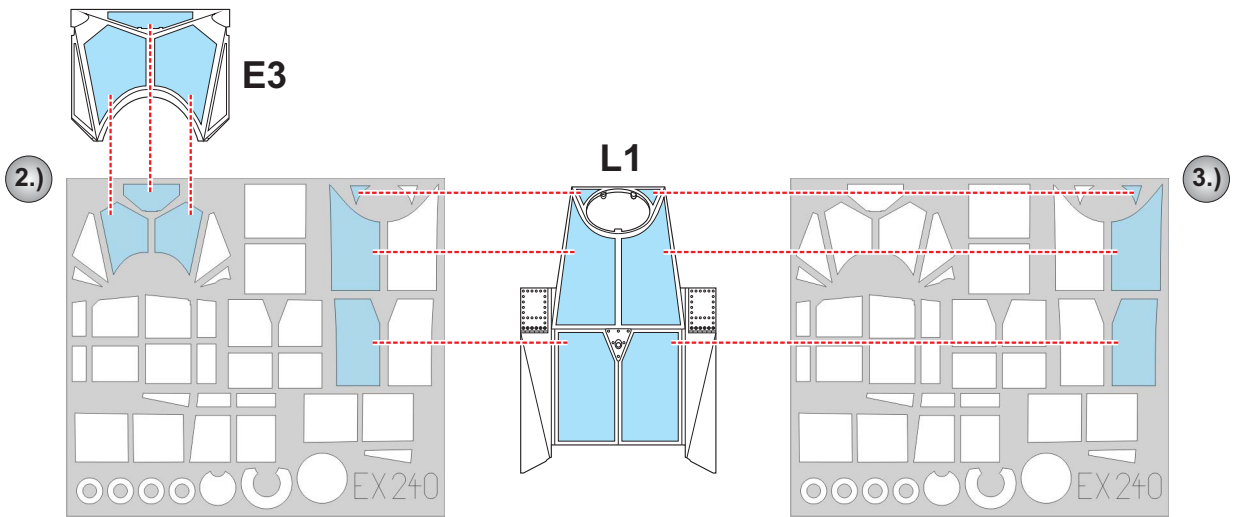
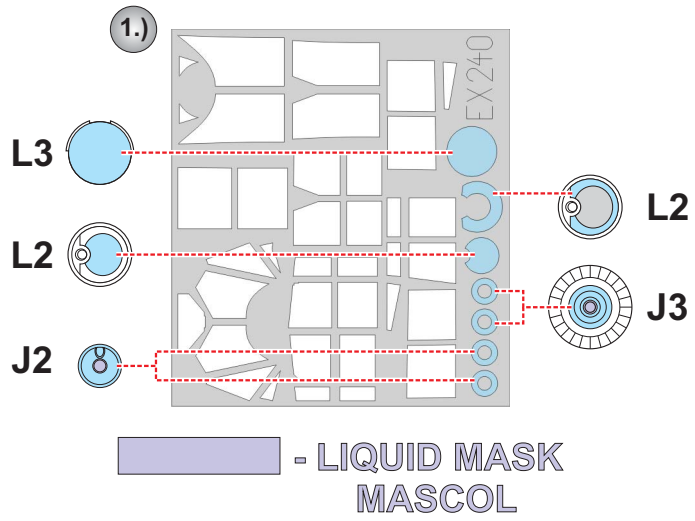
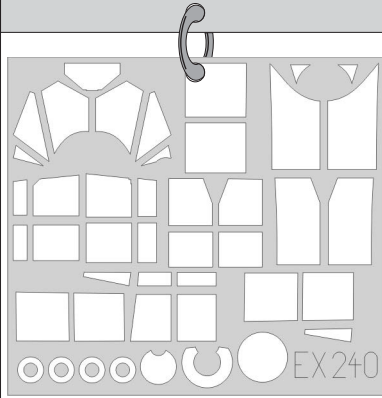

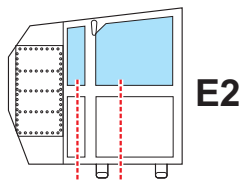

6.)

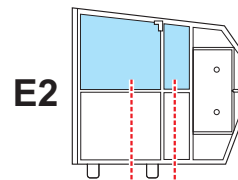
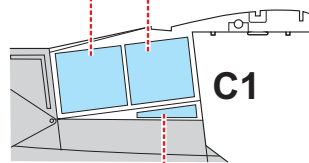
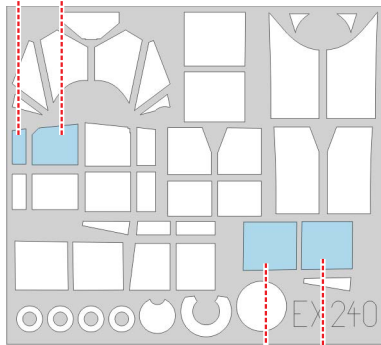

7.)

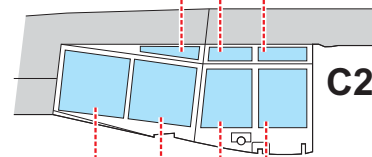
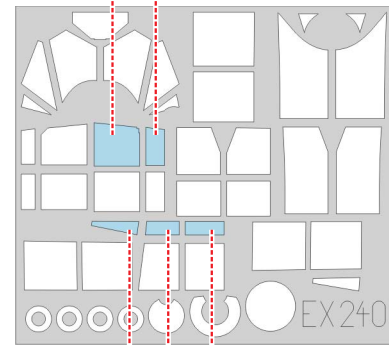

8.)

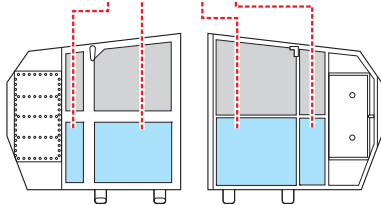
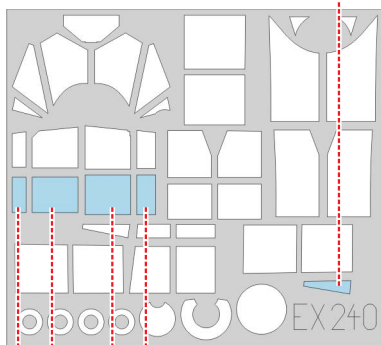

9.)

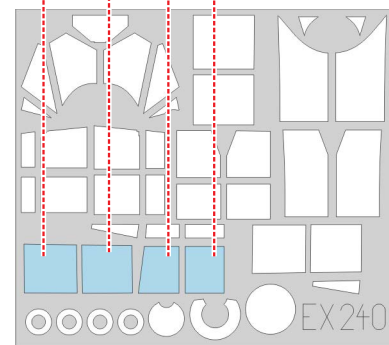

10.)



**INTERIOR COLOR
BARVA INTERIÉRU**

11.)



**CAMOUFLAGE COLOR
BARVA KAMUFLÁŽE**

12.)

**REMOVE MASK
ODSTRANIT MASKU**